



**Model Number** GR3-AL-TF-145JP-4-B-D-1.5-230|460-60

**MFG PN** TFC145T1.5U4B

**List Price** --

All data shown at HIGH voltage setting

Format | STD 3 Phase

Electrical Data				General Data	
Rated Motor Output Power	1.5 HP			Frame Size	145
Rated Motor Speed	1740 r/min			Enclosure	TEFC
Rated Motor Voltage (3 Phase)	230 460-60 Volts - HZ			Approximate Weight	47.52
Rated Motor Current	4.4/2.2 Amps			NEMA Design	B
Service Factor	1.25			IP Rating	55
KVA Code	L			Insulation Class	F
Nominal Efficiency	86.5 %			Tropicalization	YES
Nominal Power Factor	0.75 cosθ			Duty	Cont.
Full Load Torque Ft-Lb	4.4256 Ft-Lb			Cable Entry	1.25
Temp Rise @ Full Load °C	36.8			Feet Removable	YES
Efficiency Level	IE3 - NEMA Premium			Double Drilled	NO
Load Data	RPM	Trq %FL	Current Amps	Rated Ambient (°C)	40
Locked Rotor	-	311	16.74	Rated Altitude (M)	1000
Breakdown	-	351	-	Coating	7024 - Graphite Grey
Pull Up	-	216	-	Shaft Grounding	NO
125% of FL	1732	-	2.5	Brake Voltage (DC)	
75% of FL	1762	-	1.75	Brake Torque (N-M)	
50% of FL	1775	-	1.47	Mechanical Data	
No Load	1796	-	1.19	Bearing DE Side	6205ZZ
Hazardous Location	Class 1, Div 2, Grp A,B,C,D			Bearing NDE Side	6205ZZ
				Moment of Inertia	kg.m2
				Noise Level	Per NEMA dB (A)
CT VFD Range		--		Loaded Torque Curves	
				P1 = INPUT POWER (KW), S = Slip (% of Sync RPM), η = Efficiency (%), cosφ = Power Factor	
Certifications	UL	CSA	DOE		
File Numbers	323353	224693	096A		
Wiring Diagram	3PH 9 Lead Dual Voltage				
<b>3 Phase - YY/Y - 9 Lead</b> 4,1 Blue / 5,2 White / 6,3 Org / 7 Yl / 8 Blk / 9 RD Cast Iron- 1,2,3 Top - 4,5,6,7,8,9 Bottom Aluminum - 4,5,6,8,9 Top - 1,2,3,7 Bottom					
<b>CONNECTIONS</b> 					

FRAME: 145JP	HP:	RPM:	PHASE: 3	VOLT: 115/208-230V	ENCL: TEFC	FREQ: 60 Hz	FLA:	LRA:
--------------	-----	------	----------	--------------------	------------	-------------	------	------

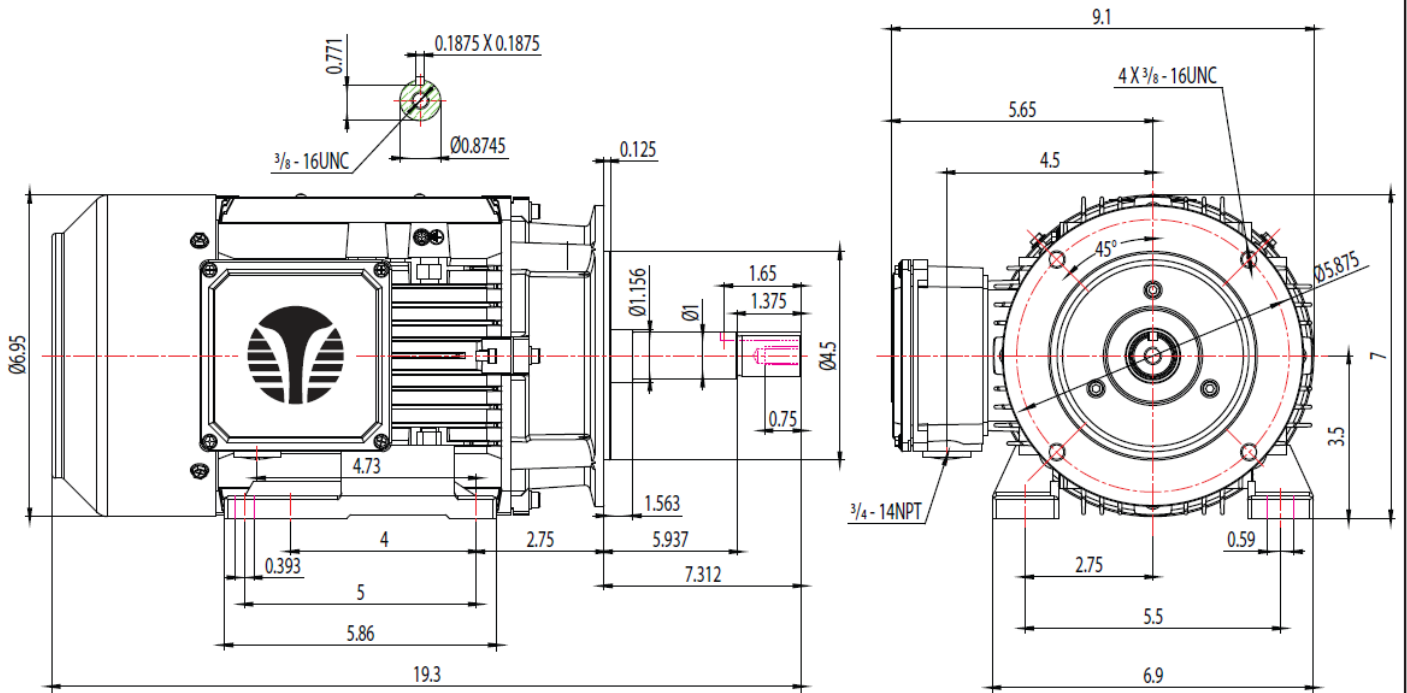

MODEL NUMBER:

GR3-AL-TF-145JP

MFG PN:

REV. BY DATE

1

2

3

4

5

6

7

CHANGES

MATERIAL: ALUMINUM

UNITS: INCH BY: SSEE

DRAWN: 6/11/2018

WWW.TECHTOP.COM